

# BLOOM TOWNSHIP SECTION 22 R12 TWP 11 MORGAN COUNTY, OH

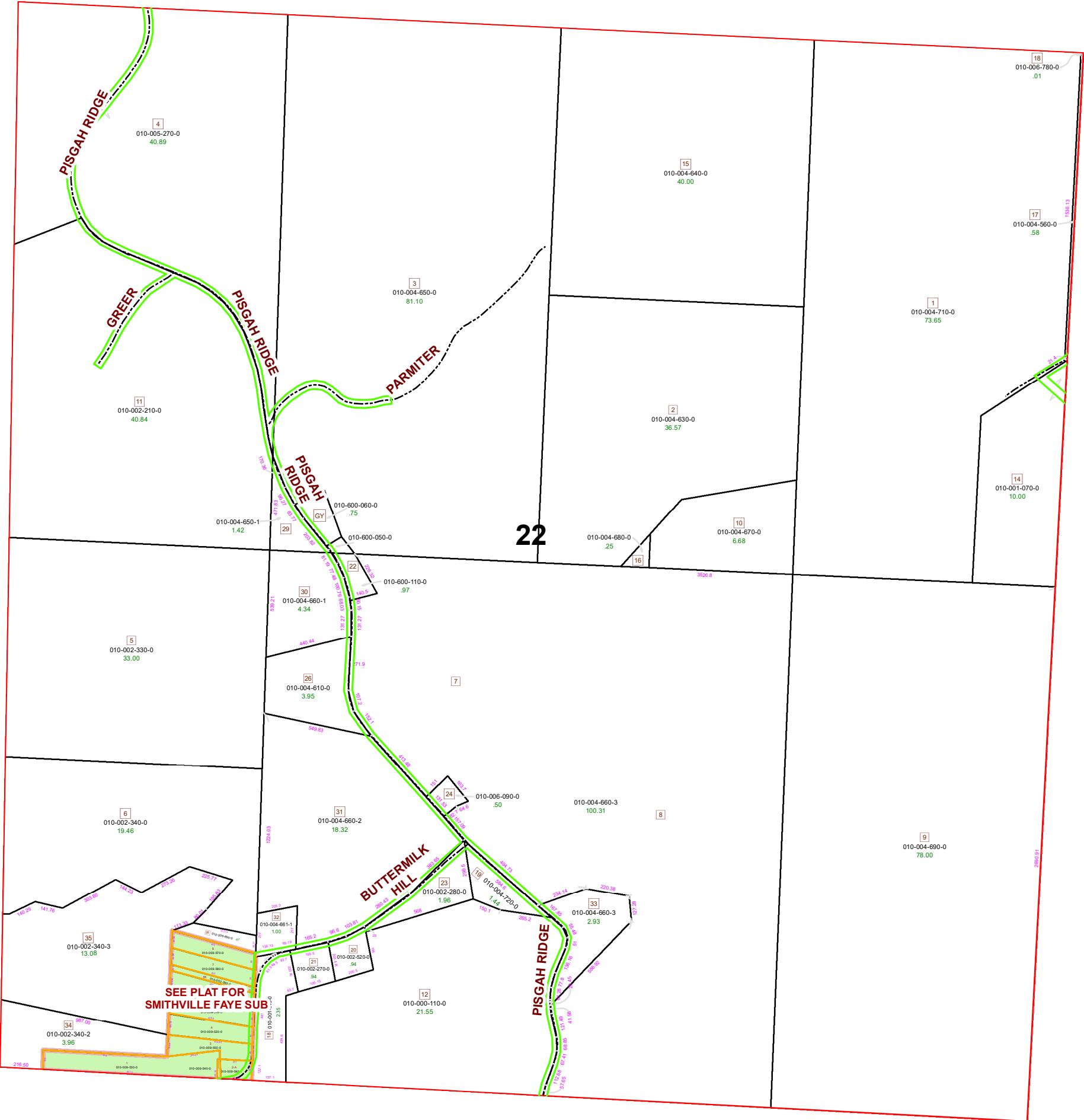

PIN	VOL	PAG	Owner	LegalDescr	Acres
010-004-661-1	OR106	679	APPERSON ANTHONY D JR & KELLY	R12 T11 S22 SD 32	1
010-000-110-0	OR193	501	APPERSON JLEE	R12 T11 S22 SD 12-	21.557
010-600-060-0	VOL. V	49	CEMETERY (PISGAH)	R12 T11 S22 LOT 3	0.75
010-600-050-0	D.V 117	510	CEMETERY (PISGAH)	R12 T11 S22 0	1
010-004-710-0	OR234	1618	CHIPPS DONNA M TRUSTEE	R12 T11 S22 SD 1	73.65
010-002-330-0	OR55	386	DOWNING RONALD W	R12 T11 S22 SD 5	33
010-002-340-0	OR55	386	DOWNING RONALD W	R12 T11 S22 SD 6	19.46
010-001-070-0	OR231	5036	GIBEAUT MICHAEL L TOD MARY BET	R12 T11 S22 SD 14	10
010-002-210-0	OR210	495	GREER CHARLES G & SONJA M	R12 T11 S22 SD 11	40.84
010-002-270-0	OR189	270	HALL CHRISTOPHER C	R12 T11 S22 SD 21	0.942
010-002-280-0	OR113	764	HALL SUE A TOD-JACQULYN S KNO	R12 T11 S22 SD 23	1.96
010-002-520-0	OR79	693	HEMRY CHERYL ANN	R12 T11 S22 SD 20	0.941
010-001-040-0	OR192	410	MCKEE STEVEN D & JOANNE D	R12 T11 S22 SD 18	2.35
010-002-340-3	OR230	1258	MILLER DANNY L	R12 T11 S22 SD 16	13.08
010-006-890-0	OR 231	3620	MITCHELL WAYNE E	R12 T11 S22 SD 28	0.67
010-004-660-3	OR214	2955	PARMITER CHAD A & CASSANDRA R	R12 T11 S22 SD 33	2.93
010-004-720-0	OR235	74	PARMITER CHARLES K	R12 T11 S22 SD 19	1.44
010-004-690-0	OR235	74	PARMITER CHARLES K	R12 T11 S22 SD 9	78
010-004-660-0	OR235	74	PARMITER CHARLES K	R12 T11 S22 SD 7-8	100.31
010-004-660-2	OR9	678	PARMITER DAVID D & BRENDA G	R12 T11 S22 SD 31	18.325
010-004-610-0	OR201	230	PARMITER DAVID D & BRENDA G	R12 T11 S22 SD 26	3.95
010-004-660-1	OR9	678	PARMITER DAVID D & BRENDA G	R12 T11 S22 SD 30	4.345
010-004-680-0	OR18	130	PARMITER DAVID D & BRENDA G	R12 T11 S22 SD 16	0.25
010-004-670-0	OR18	130	PARMITER DAVID D & BRENDA G	R12 T11 S22 SD 10	6.68
010-004-650-1	OR9	678	PARMITER DAVID D & BRENDA G	R12 T11 S22 SD 29	1.429
010-004-630-0	OR18	130	PARMITER DAVID D & BRENDA G	R12 T11 S22 SD 2 S	36.57
010-004-640-0	OR18	130	PARMITER DAVID D & BRENDA G	R12 T11 S22 SD 15	40
010-004-650-0	OR223	1635	PARMITER DAVID D & BRENDA G	R12 T11 S22 SD 3 S	81.101
010-006-090-0	OR232	2431	PEPPER ISAAC M	R12 T11 S22 SD 24	0.5
010-005-270-0	OR231	2218	ROBINSON MARY BETH TOD: MICHAEL	R12 T11 S22 SD 4 T	40.89
010-002-340-2	OR226	2368	TOTMAN RANDALL J & CANDACE V	R12 T11 S22 SD 34	3.96
010-600-110-0	D.V 125	152	TRUSTEES OF PISGAH CHURCH	R12 T11 S22 SD 22	0.97

**Boundaries**

- Lot
- ROW
- Section
- - - - Hidden
- - - - Township
- - - - Symbols
- Roads
- Sections
- Parcels

Disclaimer: The Information that these maps contains is for reference purposes only. Please bring any errors to the attention of the Engineer's Office staff. Thank You

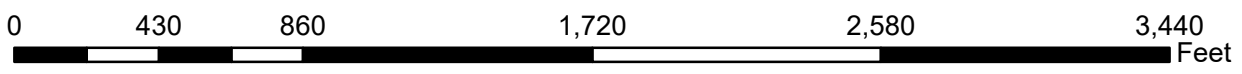

Morgan County Engineer's Office  
 Author: Marcia Wolfe  
 Date: 7/20/2020